

TYPE	A	B	D	E	F	F1	G	H	I	J	K	L	M	Weight [kg]
...COA 1-09	90												59	3.9
...COA 1-10	100												69	3.9
...COA 1-12	120												80	4.0
...COA 1-14	140	150	115	130	70	90	25	99.5	2.5	5	G 3/4"	100	100	4.0
...COA 1-17	170												130	4.1
...COA 1-22	220												180	4.2
...COA 1-27	270												230	4.3
...COA 2-09	90												59	3.9
...COA 2-10	100												69	3.9
...COA 2-12	120												80	4.0
...COA 2-14	140	150	115	130	70	90	25	99.5	2.5	5	G 3/4"	100	100	4.0
...COA 2-17	170												130	4.1
...COA 2-22	220												180	4.2
...COA 2-27	270												230	4.3
...COA 4-10	100												69	4.2
...COA 4-12	120												80	4.3
...COA 4-17	170	156	115	130	70	90	25	99.5	2.5	5	G 3/4"	100	130	4.4
...COA 4-22	220												180	4.5
...COA 4-27	270												230	4.6
...COA 6-12	120												80	5
...COA 6-17	170	171	115	130	70	90	25	99.5	2.5	5	G 3/4"	100	130	5.1
...COA 6-22	220												180	5.2
...COA 6-27	270												230	5.3
...COA 10-17	170												110	7.3
...COA 10-27	270	231	160	180	100	100	32	130	4	8	G 1 1/4"	140	210	7.8
...COA 10-35	350												290	8.2
...COA 14-17	170												110	7.3
...COA 14-27	270	231	160	180	100	100	32	130	4	8	G 1 1/4"	140	210	7.8
...COA 14-35	350												290	8.2
...COA 16-18	180												110	8.1
...COA 16-28	280	231	160	180	100	100	32	130	4	8	G 1 1/4"	140	210	8.6
...COA 16-36	360												290	9
...COA 25-18	180	276	160	180	100	100	32	138	4	8	G 1 1/4"	140	90	9.7

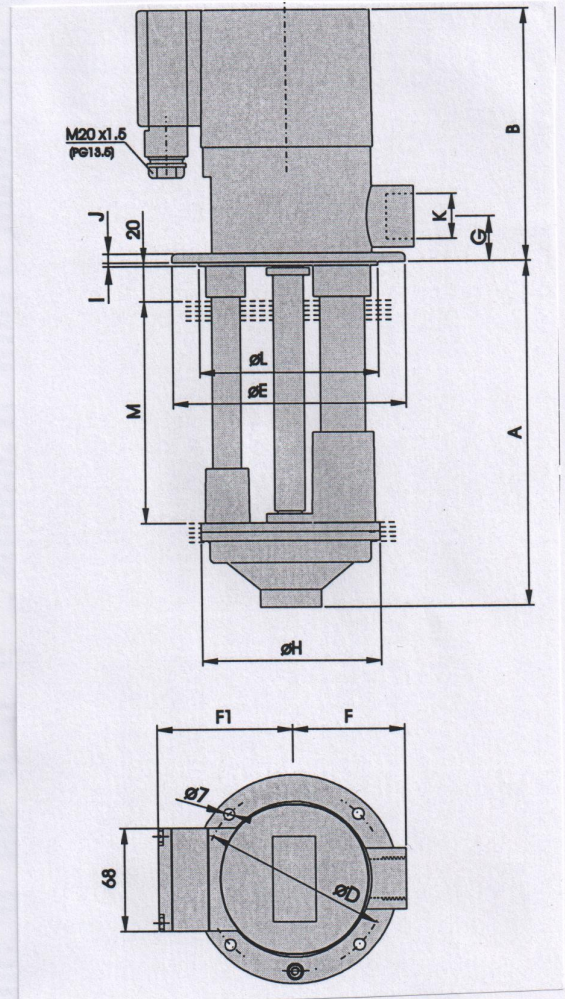

Curves of 3COA (9COA) pumps (viscosity 1 to 150 mm<sup>2</sup>. s<sup>-1</sup>)

